

# Portex™ Thermovent™ T2 Heat and Moisture Exchanger (HME)

Providing a clear choice

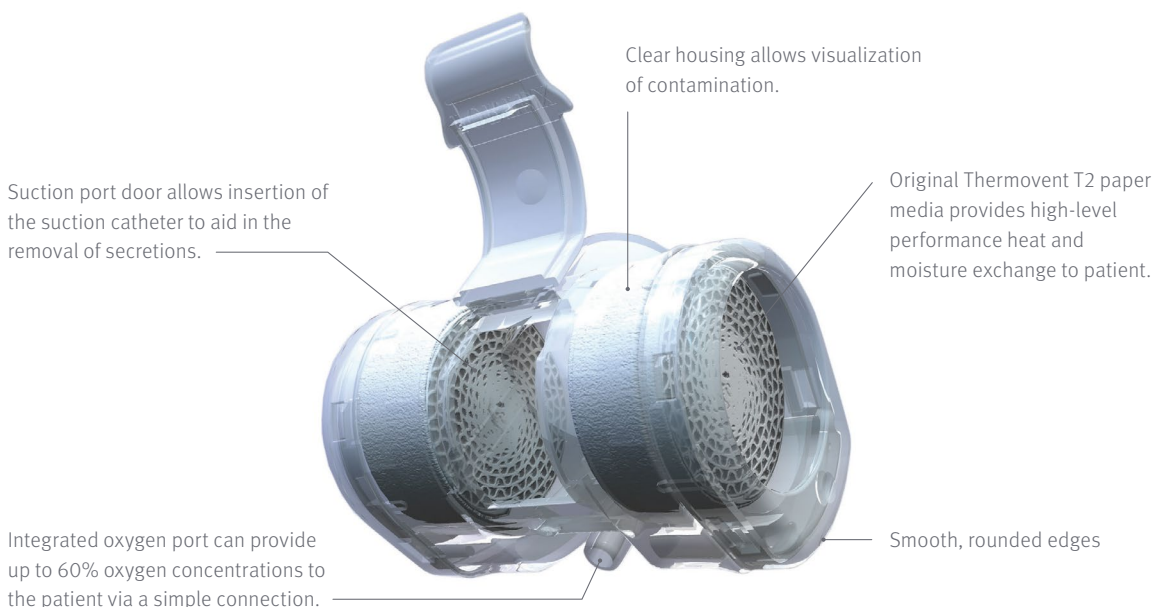

## Thermovent T2 HME

- › Sterile, single-use HME
- › Provides effective humidification for spontaneously breathing patients whose upper airways are bypassed by a tracheostomy or tracheal tube.
- › Device can be used for up to 24 hours.
- › Port for administering supplemental oxygen and a port to allow removal of secretions by suction

## Indications for use

- › For use on adult and pediatric patients with a tidal volume more than 70 mL
- › Reduction of heat loss through the broncho pulmonary tree
- › Helping to prevent thickened secretions and changes in lung function
- › Supplying additional oxygen when required
- › Facilitating the removal of secretions
- › Preserving humidity and minimizing damage to tracheal epithelial cells

## Thermovent T2 HME specifications

Oxygen flow rates/inspired oxygen concentration

O <sub>2</sub> L/min	1	2	3	4	5	6	7	8	9	10
O <sub>2</sub> %	27	33	37	42	45	47	53	54	57	60

Moisture output: 25 mg/l H<sub>2</sub>O at 15 breath/min, tidal volume 500 mL

Resistance to flow

0.3 hPa (cm H <sub>2</sub> O) at gas flow rate 0.5l sec <sup>-1</sup> (30l min <sup>-1</sup> ) [0.6cm H <sub>2</sub> O l <sup>-1</sup> sec <sup>-1</sup> ]
0.7 hPa (cm H <sub>2</sub> O) at gas flow rate 1.0l sec <sup>-1</sup> (60l min <sup>-1</sup> ) [0.7cm H <sub>2</sub> O l <sup>-1</sup> sec <sup>-1</sup> ]
1.2 hPa (cm H <sub>2</sub> O) at gas flow rate 1.5l sec <sup>-1</sup> (90l min <sup>-1</sup> ) [0.9cm H <sub>2</sub> O l <sup>-1</sup> sec <sup>-1</sup> ]

Dead space: 11 mL

Tidal volume range: 70–500 mL

Ordering information

Product Code	Description
100/570/022	Thermovent T2 Heat and Moisture Exchanger



Thermovent T2 has built-in suction and oxygen ports.

# Using the Thermovent T2 HME with a tracheostomy tube



1  
Device should be oriented with the oxygen port on its underside when placed on the 15 mm connector of the tracheostomy tube.

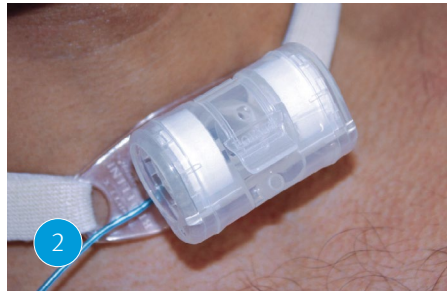

2  
Suction port should remain closed when not in use.



3  
When suctioning is required, open the suction port door to allow insertion of the suction catheter.



4  
Insert suction catheter and commence suctioning. Take care not to scrape secretions onto the port door.



5  
When suctioning is complete, remove the suction catheter and close the suction port door.

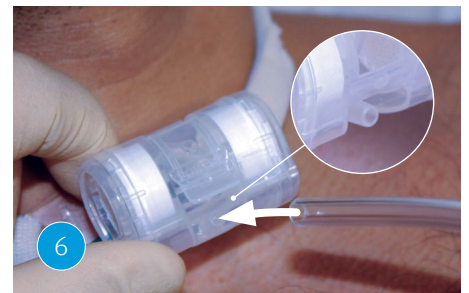

6  
If supplementary oxygen is required, an oxygen line can be connected to a suitable oxygen source.



7  
Oxygen flow should be controlled according to the patient's requirements.

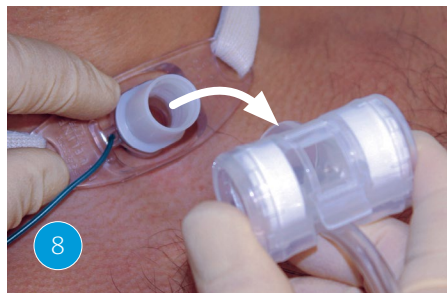

8  
Thermovent T2 device should be removed from the tracheostomy tube prior to disconnecting the oxygen line to avoid risk of decannulation.

