



# Important

Please open this form in Adobe Acrobat.  
It has interactive elements which may not function correctly  
if opened in your web browser.

If you don't have Adobe Acrobat Reader installed, you can download it here:

<https://get.adobe.com/reader/>

# Bivona™ Customised FlexTend™ Tracheostomy Tube Template

## 1. Shaft Length

1a. Shaft Length \_\_\_\_\_ mm (5 mm min, 60 mm max)

1b. Shaft Length \_\_\_\_\_ mm (30 mm min, 140 mm max)

## 2. Shaft

I.D.	O.D.	I.D.	O.D.	I.D.	O.D.	I.D.	O.D.	I.D.	O.D.
<input type="radio"/> 2.5	4.0	<input type="radio"/> 4.0	6.0	<input type="radio"/> 5.5	8.0	<input type="radio"/> 7.0	10.0	<input type="radio"/> 8.5	11.8
<input type="radio"/> 3.0	4.7	<input type="radio"/> 4.5	6.7	<input type="radio"/> 6.0	8.7	<input type="radio"/> 7.5	10.4	<input type="radio"/> 9.0	12.3
<input type="radio"/> 3.5	5.3	<input type="radio"/> 5.0	7.3	<input type="radio"/> 6.5	9.4	<input type="radio"/> 8.0	11.0	<input type="radio"/> 9.5	13.3

## 3. Connector (check one box only)

☐ 3a. Swivel 2.5–9.5 mm ☐ 3b. Fixed 2.5–6.0 mm

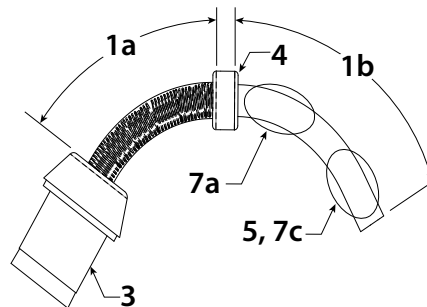
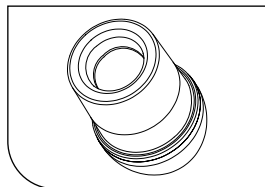
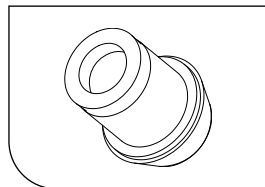

## 4. Neck Flange (check one box only)

☐ 4a. 2.5–6.0 mm

☐ 4c. 2.5–9.5 mm

☐ 4d. 6.5–9.5 mm

☐ 4e. 2.5–4.0 mm

☐ 4f. 2.5–6.0 mm

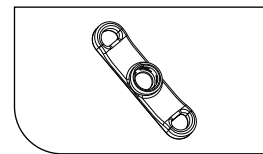
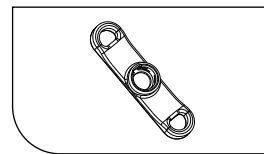
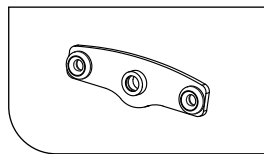
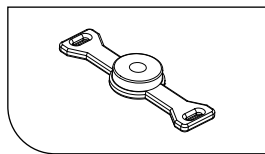
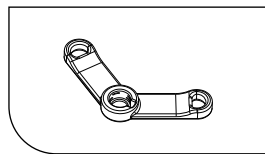

Neck Flange Length: 60 mm

Neck Flange Length: 83 mm

Neck Flange Length: 67 mm

Neck Flange Length: 47 mm

Neck Flange Length: 60 mm

## 5. Cuff (check one box only)

☐ 5a. TTS Tight to Shaft

☐ 5b. Aire-Cuf™ Pedi

☐ 5b. Aire-Cuf Adult

☐ 5c. Fome-Cuf™ Adult

☐ 5d. Cuffless

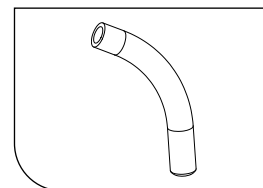
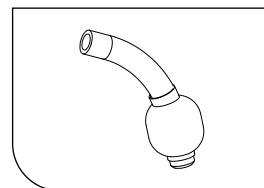
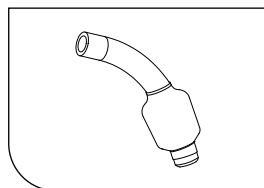
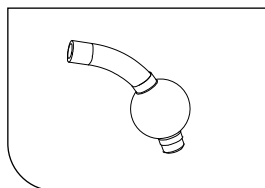
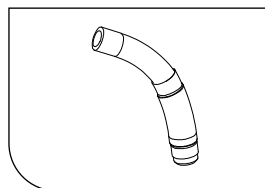

2.5–9.5 mm

2.5–5.5 mm

5.0–9.5 mm

2.5–9.5 mm

2.5–9.5 mm

## 6. Shaft Option

☐ 6a. Shaft (Only proximal section is wire reinforced.)

☐ 6b. Hyperflex

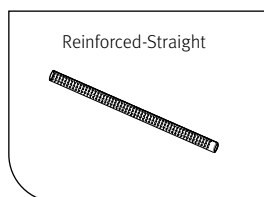
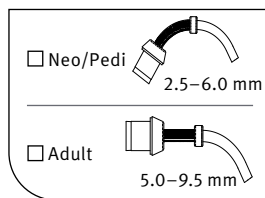

2.5–9.5 mm

## 7. Optional

☐ 7a. Proximal (Top) Cuff

☐ 7b. Stoma Seal

☐ 7c. Distal (Bottom) Cuff

☐ TTS Cuff

☐ Aire-Cuf

☐ Fome-Cuf

☐ Pediatric

☐ Adult

Cuff position from Neck Flange \_\_\_\_\_ mm

Note: Minimum distance 2 mm

☐ Solid Silicone

\_\_\_\_\_ mm O.D.

\_\_\_\_\_ mm Length

☐ Tapered

☐ Non Tapered

Cuff distance from tip to shaft \_\_\_\_\_ mm  
Note: Cuff distance from tip cannot be less than the minimum standard distance listed below:

a. Pediatric TTS, Aire-Cuf & Fome-Cuf – 3 mm

b. Adult Aire-Cuf & Fome-Cuf – 5 mm

c. Adult TTS – 9 mm

☐ 7d. Talk Attachment

5.0 mm I.D. Adult shaft or above only

## 8. Approval Please note: ICU Medical will review the completed template for compliance.

Any required modifications will be made with the approval of a clinician.

Hospital/Clinic \_\_\_\_\_

Clinician Name \_\_\_\_\_ Clinician Title \_\_\_\_\_

P.O. Number \_\_\_\_\_ Date \_\_\_\_\_

## 9. Select Type of Service

☐ Standard service (sterile)

☐ Express service (non-sterile)

☐ Standard service (non-sterile)

Our Terms and Conditions of Sale for Europe (<http://www.icumed.com/support/customer-support-documents/terms-and-conditions-of-sale>) are the only terms or conditions which apply to any contracts between ICU Medical group companies ("ICU Medical") and a customer in relation to purchases of products and/or services. Unless otherwise authorised by ICU Medical in writing, no other terms shall apply between ICU Medical and any customer for the purchase of such products or services.

The product complies with current legislation and has the corresponding CE marking.

For additional information, warnings and / or safety precautions, refer to the Instructions for Use.

© 2025 ICU Medical, Inc. | P25-6250-3-EMEA-UK

**icumedical**  
human connections

Phone: +44 (0)845 850 0445

Email: [bco@icumed.com](mailto:bco@icumed.com)

Web: [www.icumed.com](http://www.icumed.com)